

# REED SWITCH MKA-36701

## CONTACT FORM A NORMALLY OPEN CONTACTS

Switching current 1 A

Switching power 30 W, VA

Switching voltage 230 V

Pull in range 50...80 AT

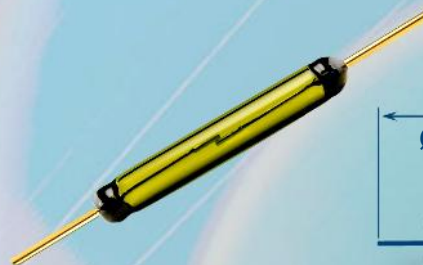

### Electrical Data

Release range, AT, min	15
Carry current, A	1 (12 impulse)
Breakdown voltage	
V, not less, AC/DC	500/700
Resetting Ratio	0,3...0,95
Contact resistance, $\Omega$ , not more	0,15
Operating time including bounce, ms, not more	2
Release time including bounce ms, not more	2
Capacitance, pF, not more	1
Insulation resistance, $G\Omega$ not less	1
Operating frequency, Hz	50 (20 impulse)
Switching current frequency, kHz, not more	100

### Environmental Data

Contact material	Ru
Life expectancy, switching cycles $\times 10^6$ max load power... low load power	0,02...5
Vibration (1...600 Hz), g, not more	10
Resonant frequency, Hz	700
Shock (1 $\pm$ 0,3) ms, g, not more	150
Weight, g, not more	1,8
Operating temperature, $^{\circ}C$	-60...125
Humidity, %, not more	98

### Certificates

### Test Coil

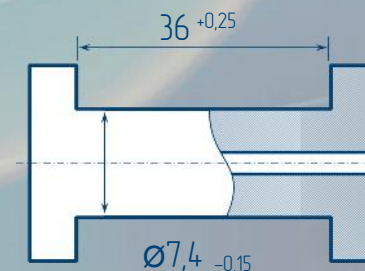

5000 turns, wire  $\varnothing 0,1$  mm  
coil resistance 327  $\Omega$

### Order information

Delivery of reed switches with formed and/or cropped leads and with narrow pull in ranges is available by agreements.



RYAZAN METAL CERAMICS INSTRUMENTATION PLANT, JSC  
51V, Novaya St., 390027, Ryazan, Russia  
Phone: +7 (4912) 240-234, Факс: +7 (4912) 240-234 E-mail: oves@rmcip.ru

Update on 12 Feb 2016

